

## Data sheet

### Support roller RNA 2210.2RS (crowned, with seal)

Designation	RNA 2210.2RS
Type	crowned
D [mm]	90
d [mm]	50
F, Fw * [mm max.]	58
B1 [mm]	23
B [mm]	22,7
r [mm]	1,1
r1 [mm]	0,6
Dynamic load Crw[N]	28000

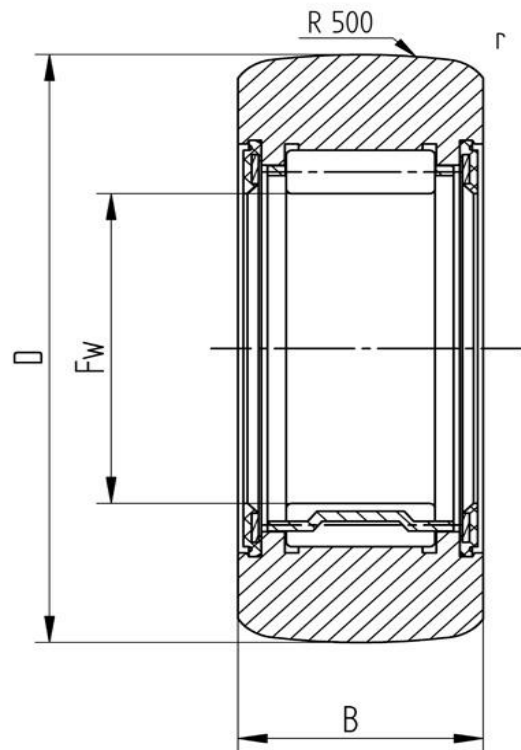

Every specification has been edited and verified carefully. STI Bearings GmbH assumes no liability for potential errors or incompleteness. Technical modifications are subject of changes.  
© 2020 by STI Bearings GmbH  
Reproduction, even excerpts, only with our approval.